

SW250 Series

SWING DOOR OPERATORS



The SW250 swing door operator combines the functions of a switch, spring, and one key recovery. Equipped with a highly efficient microprocessor, this operator optimizes the motion control of each door movement path, ensuring a precise and safe environment. Additionally, the spring tension's opening strength can be adjusted when the power is off, enhancing end user safety.

Features

- **Heavy-duty** - Capable of supporting door weights up to 250kg.
- **Convenient** - Features a push and go function for easy operation.
- **Self-closing** - In the event of a power failure, the operator will function as a normal door closer.
- **One key recovery** - Quick and easy restoration of the door closer to its default settings, simplifying maintenance and ensuring optimal performance
- **Designed with end user's safety in mind** - If the operator encounters an object and lacks a safety sensor, it will automatically reverse in the opposite direction.

Warranties	
Mechanical	1 year
Electronic	1 year

Dimensions

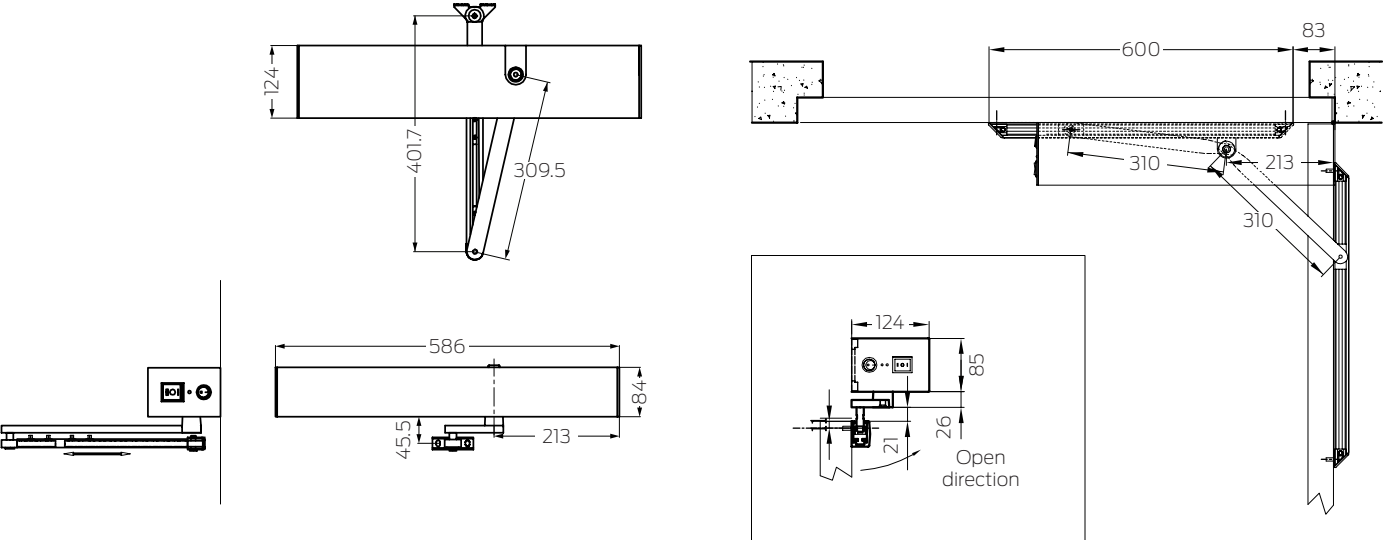

All measurements are in mm.

Technical specifications

Model	SW250
Max. Door Weight	250kg
Max. Door Width	1250mm
Opening (Closing) Speed	10° ~ 30° / S (adjustable)
Opening Angle	10° ~ 105° (max.)
Hold Open Time	2.5s ~ 30s (adjustable)
Max. Torque	50nm
Power	220V
Power Consumption	13W (standby) / 87W (rated)
IP Rating	IP21
Ambient Temperature	-20°C ~ 55°C
Function	
Self-checking	Yes
Synchronization	Yes, applicable for double leaf door
Self-closing	Yes, in the event of a fire
Manual Push Open	Yes
Automatic Reverse Function	Yes, in the event of an obstacle
Overheating Protection	Yes
Overload Protection	Yes
Safe Voltage	Yes
Fire Alarm Signal	Yes